

TURBO STOVE

Assembly Instructions

ATTENTION!

SECURITY AND WORK INSTRUCTIONS

Use gloves when assembling.

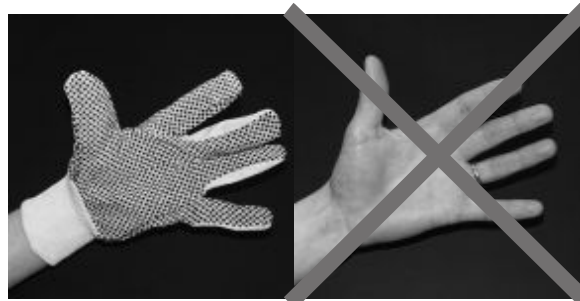

Yes

No

Use a pair of pliers and a screwdriver as working tools.

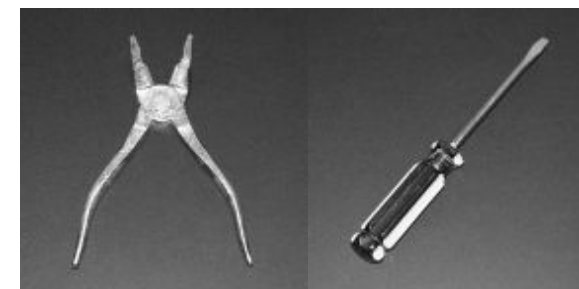

Pliers

Screwdriver

GENERAL ORIENTATION

FOLLOW THIS PART TOGETHER WITH THE PHOTOGRAPHS AND THE LAYOUT

MAIN PHASES

PICTURE NUMBERS

DETAILS

Phase A

ASSEMBLY PREPARATIONS

1-4
5-6
7

Fold the assembly kit open and straighten it by pressing it down by your feet. Separate the main parts (the body, two grates and four legs) by repeated bending. Look for more details in the LAYOUT.
Turn the OUTSIDE up. By pre-bending the locking parts to the angle shown in pictures you facilitate future installation.
Turn the OUTSIDE up. Bend (L1,L2,L3) down 90° with the help of pliers.

Phase B

ROLLING OF THE BODY

1
2
3
4
5
6-7

Turn the INSIDE up. Lift the narrow end of the plate to knee height, the parts (K1-K15) on your left side. Start bending the plate slightly down with your thumbs while holding it up with other fingers. Support the plate against your legs to get better hold for bending.
Keep shifting your hands step-by-step (3-5 cm) forward and continue bending the plate with your fingers. Keep bending position at mid-leg height. Let the lower part of the plate touch your legs to support the bending process.
Keep bending until you reach the other end of the narrow part of the plate. Bending position is at lower-leg height. If needed, repeat the bending (Pictures 1-3) to attain a round shape in the narrow end of the plate.
When you proceed to the rolling of the wider half of the plate, then place your left foot on the plate to keep it firmly on the ground. Use both hands when pushing the roll down and force it forward. Roll the plate along the long straight edge of the plate.
Keep rolling and pushing the plate down so that it gets a round shape as shown in the picture (5).
Insert locking parts (L1,L2,L3) of the free end of the plate into the long holes (H1,H2,H3) on the surface of the roll. Slide then the locking parts down to lock the free end. By rolling of the body you create the basic structure of the stove, which now has inner and outer walls.

Phase C

ASSEMBLY OF THE LEGS AND THE LOWER GRATE

1-4
5-6
7
8-13
14

Turn the stove upside down. By installing the first short leg you lock the loose end of the inner wall to the outer wall and facilitate the installation of the lower grate. Press the inner and outer walls tightly together. By installing (FL2) through the hole (FL6), ensure that (FL2) passes completely through the hole before you start bending it further at the joint (FL2/FL3) towards (FL7) for temporary locking.
Take the lower grate in the right hand and align the long straight edge of the grate with the straight part of the body. Place your left hand between the walls to assist insertion. Force both *sharp corners of (LG2) into the holes (H5,H6). By bending and forcing the lower grate inside the stove you force the inside wall into a round shape. Make sure that both corners of (LG1) slide into holes (H9,H10). *Notice that the sharp corners of (LG2) are those, which remain when the grate is separated from the body by repeated bending. Notice that the round side of the grate is left loose at this stage. It will be connected to the body later on by installing all the legs.
By bending (L7) down 90° the lower grate is supported.
Continue with the installation of the first leg and the other three legs. Make sure that (FL10,FL1) and the respective parts of the other legs are placed between the inside wall and lower grate where there are slots reserved for them. See slot (LG3) (Picture 9).
Final locking of the legs: Stand the stove on its legs. By gripping the leg in the hand and rotating slightly inwards, locate (FL10,FL1) in the slot (LG3). Place the leg on the floor making sure that (FL10,FL1) remain in the slot. Place both thumbs inside the stove either side of the slot (LG3) and press the lower grate firmly down until (FL1) clicks into place above the lower grate. Repeat for all legs.

Phase D

ASSEMBLY OF THE UPPER PART

1
2
3
4
5-8
9-11
12-17

Bend the long elements outwards 90° to create more working space.
When installing (K5,K7,K9,K11) first pre-bend the small parts (A,B) down and inwards 130°. Increase then the bending of (A1-A6) to 45° by pushing them further down and outwards with a screwdriver as a preparation of the next step.
By bending (K3,K5,K7,K9,K11,K13) you connect the inside and outside walls and force them to move into the right position. Start bending (K3,K13) inside and right down onto (A1,A6) and then (K5,K11,K7,K9) onto (A2,A5,A3,A4). By inserting the small parts (A,B) of (K5,K7,K9,K11) between the walls you help the upper structure of the stove to move and to stay in the right position.
Bend (C1,C2,C3,C4,C5) outwards and onto (K3,K5,K7,K9,K11,K13).
By bending the long parts (K2,K8,K14) you create lower level pot-holders for smaller pots inside the stove. When installing (K2) use a screwdriver to widen the space between the walls to assist in pushing (K2A,K2B) into the hole (K19) (Picture 7). Install (K14) the same way as (K2). When installing (K8) the locking parts (K8A,K8B) click easily into hole (H18), because of the wider space between the walls.
First insert the loose end (A) of (K1,K15) between the walls to build upper level pot-holders. Bend then the locking ends (L4,L5,L6) inwards 180° thus creating the firewood opening. Finally *double-bend the top of (K1,K15) inwards 90° at joints (A/B and C/D). *Double-bending means that two joints, which are besides each other are bent at the same time.
By bending the upper level pot-holders (K4,K6,K10,K12) you create place for bigger size of cooking items of various type.

Phase E

ASSEMBLY OF THE UPPER GRATE

1-6

By the installation of the upper grate you have now completed the stove construction. Great work!

LAYOUT

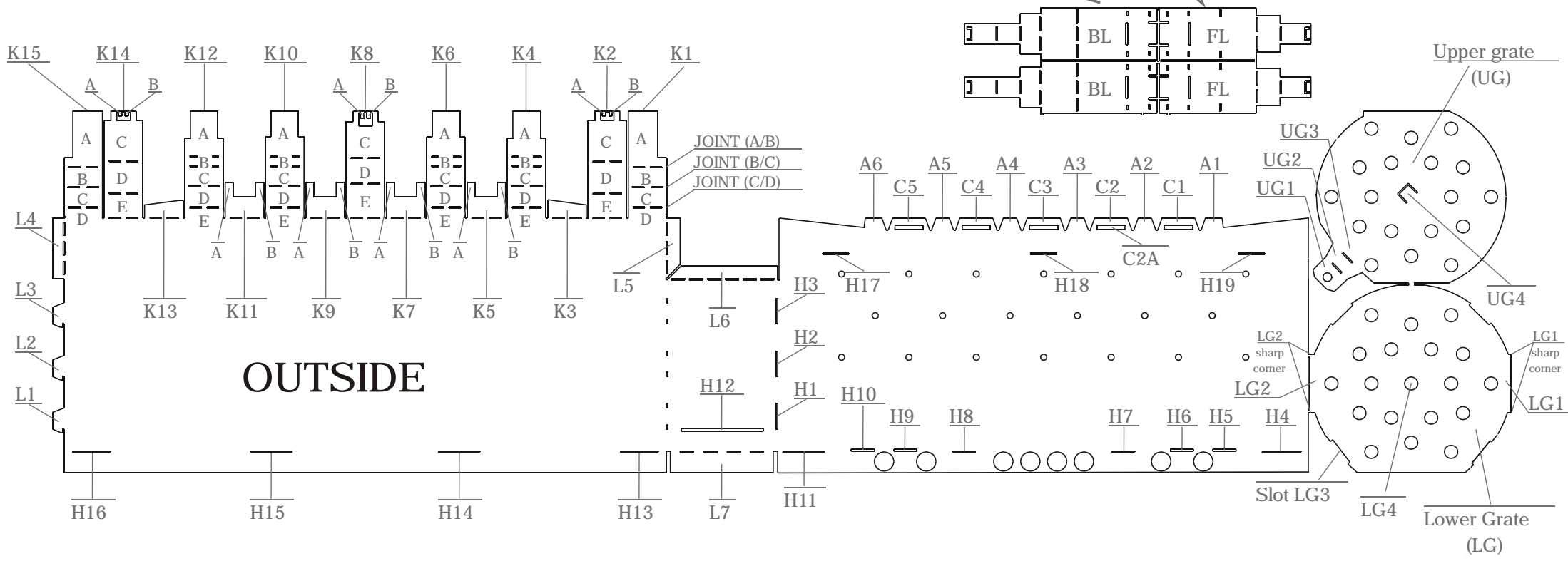
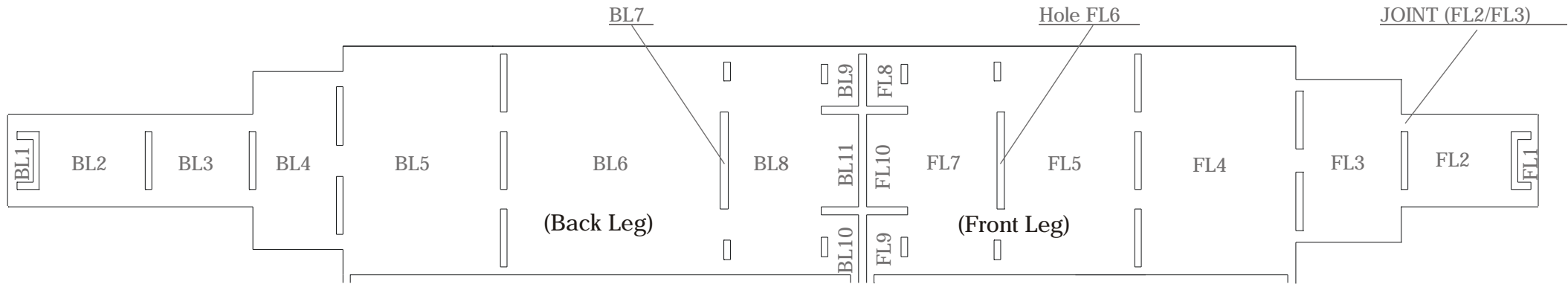

TURBO STOVE Phase A ASSEMBLY PREPARATIONS

Assembly Instructions



1 As packed.

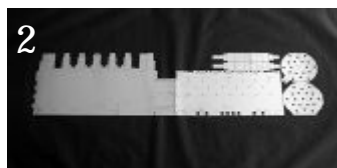

2 Use gloves! Fold the plate open and straighten it.

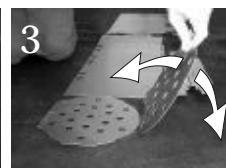

3 Separate the main parts by repeated bending.



4 Main parts. Look for more details in the LAYOUT

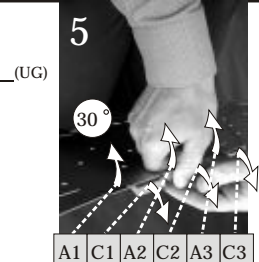

5 Turn the up. OUTSIDE. Bend (A1-A6) up 30°. Bend (C1-C5) down 30°. Use hands or pliers as tools.

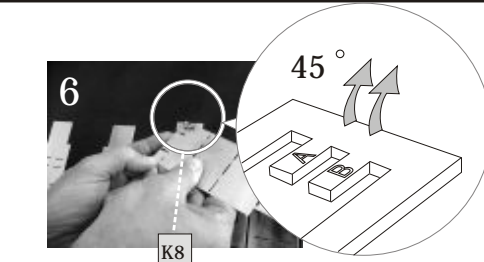

6 Bend (A,B) up 45° when preparing (K2,K8,K14). Use a leg or a screwdriver as a tool.

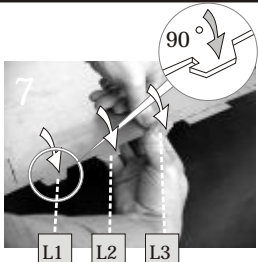

7 Turn the OUTSIDE up. Bend (L1, L2, L3) down 90°. Use pliers.

Phase B ROLLING THE BODY



1 Turn the INSIDE up. Lift narrow end of the plate to knee height. Support the plate against your legs. Start bending and rolling.



2 Bend and roll. Using thumbs and fingers. Shift your hands step-by-step (3-5 cm) forward.



3 Shift your hands step-by-step (3-5cm) forward and complete the bending of the narrow part of the plate. If needed, repeat the bending (pictures 1-3)

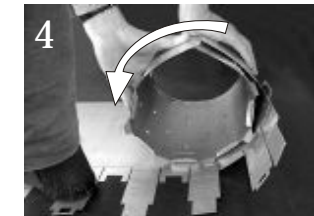

4 Put your left foot on the wider part of the plate. Force the roll forward with both hands.

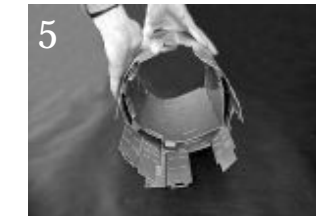

5 Force the plate into a round shape. Release your hands and insert (L1,L2,L3) into (H1,H2,H3).

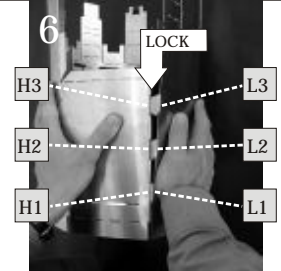

6 Turn the unit upright. Keep (L1,L2,L3) in (H1, H2,H3). Slide (L1,L2,L3) down to lock the body.

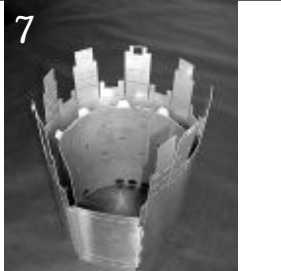

7 The body is now rolled and locked.

Phase C ASSEMBLY OF THE LEGS AND THE LOWER GRATE

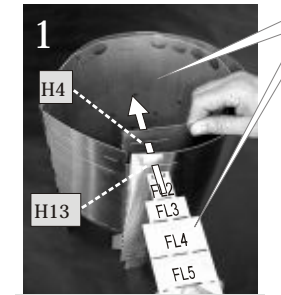

1 Turn the stove upside down. Insert the short front leg (FL) through the holes (H13, H4).

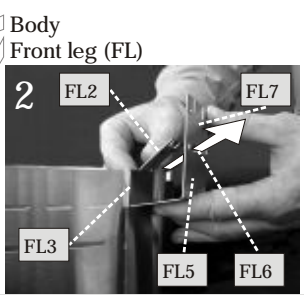

2 Press the inside and outside walls together and bend (FL2,FL3) up 90°. Bend (FL5,FL7) up 90°. Bend (FL2) further 45° and insert it in the hole (FL6).

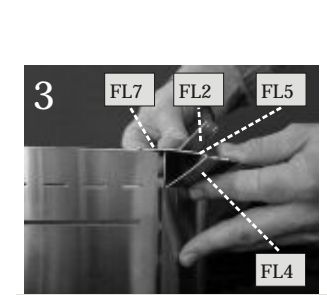

3 Press the inside and outside walls together. By bending (FL4) up 45° (FL5,FL7) move into a horizontal position and (FL2) slides through hole (FL6).

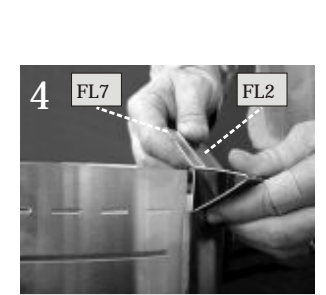

4 Bend (FL7) up 45°. Bend (FL2) towards (FL7) so that they come together. The partly installed leg now keeps the inside and outside walls together.

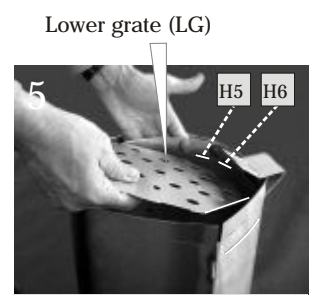

5 Take lower grate (LG) and insert the sharp corners of (LG2) into holes (H5,H6). Place your left hand between the walls to assist insertion.

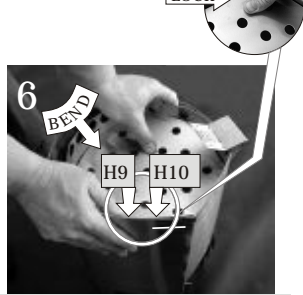

6 Bend lower grate (LG) and force the sharp corners of (LG1) down until they lock into (H9, H10).

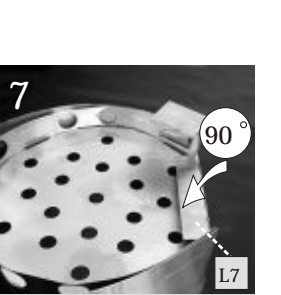

7 Bend (L7) down 90° to support the lowergrate (LG).

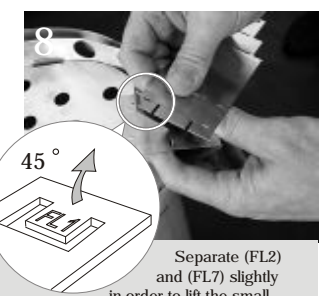

8 Separate (FL2) and (FL7) slightly in order to lift the small locking part (FL1) up 45°. Use another leg or a screwdriver as a tool.

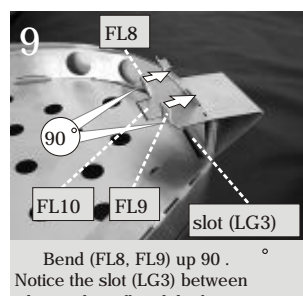

9 Bend (FL8, FL9) up 90°. Notice the slot (LG3) between the inside wall and the lower grate. Notice (FL10).

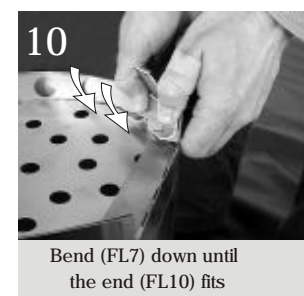

10 Bend (FL7) down until the end (FL10) fits into the slot (LG3).

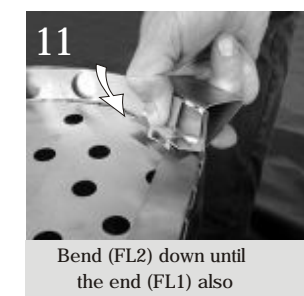

11 Bend (FL2) down until the end (FL1) also fits into the slot (LG3).



12 Leg position before finale locking. Assemble the remaining legs: pictures (1-4) and (8-12).

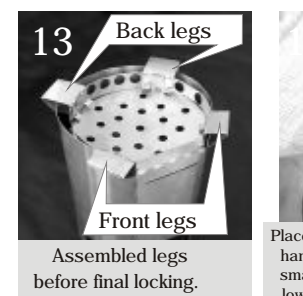

13 Assembled legs before final locking.

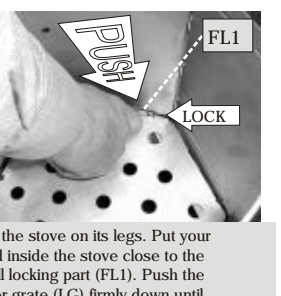

14 Place the stove on its legs. Put your hand inside the stove close to the small locking part (FL1). Push the lower grate (LG) firmly down until the (FL1) clicks above the lower grate (LG). Repeat for all legs.

Phase D ASSEMBLY OF THE UPPER PART

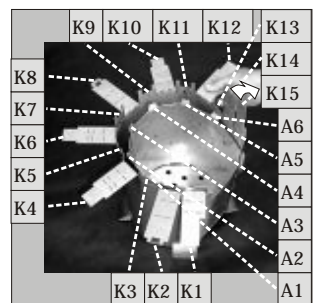

Bend (K1,K2,K4,K6, K8,K10,K12,K14,K15) down to the outside 90° at the lowest joint.

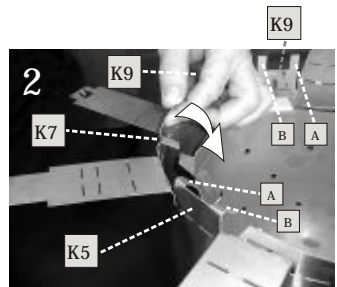

2 Bend (K5A,K5B)(K7A,K7B) (K9A,K9B)(K11A,K11B) down to the inside 130°. Push (A1-A6) further down and outwards to 45°.

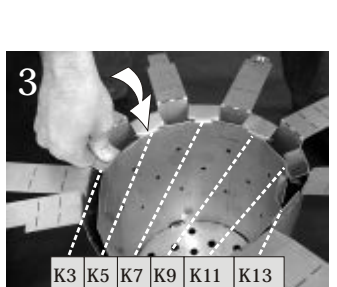

3 Bend first (K3,K13) and then (K5, K11)(K7,K9) right down onto (A1-A6), while inserting the small parts (A,B) between the walls.

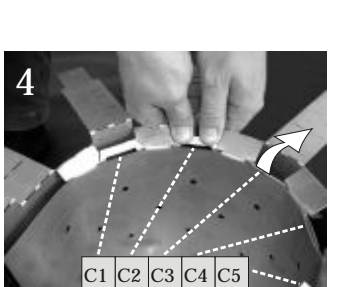

4 Bend (C1-C5) outwards onto (K3,K5,K7,K9,K11,K13).

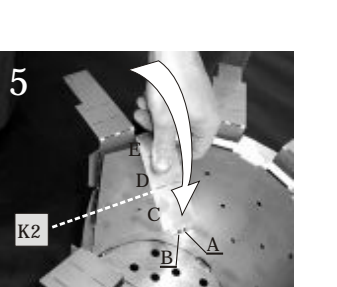

5 Turn (K2) first up 90° and further inwards 130° by bending at the lowest joint.



6 Lift (C,D) up 45° by bending at joint (D/E).

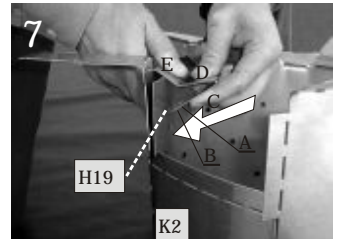

7 Turn (C) down and towards the hole (H19) by bending at joint (C/D). Push then (A,B) into the hole (H19) until they lock.

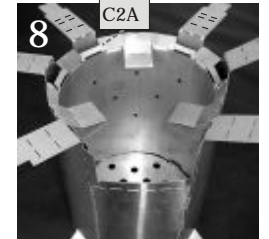

8 Assemble (K8, K14) in the same way as (K2): Pictures (5-7). Note that (C2A) refers to picture 13, where you need it.

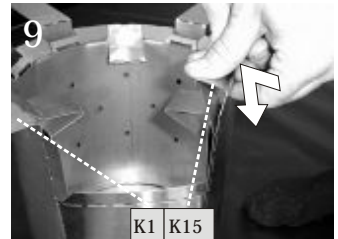

9 Turn (K1,K15) up at joint (D/C), 90° inwards at joint (C/B), 130° down and inwards at joint (B/A). Insert (A) between the walls and push it down by pressing (B,C) together in an upright position.

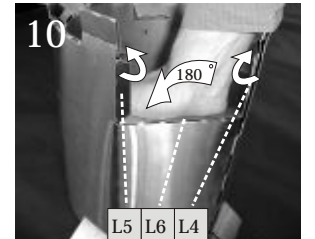

10 Turn (L6) in and down 180°.

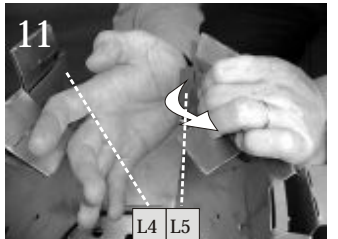

11 Turn (L4,L5) inwards 180°. Complete now (K1,K15) by double-bending inwards 90° at joints (A/B and C/D) at the same time.

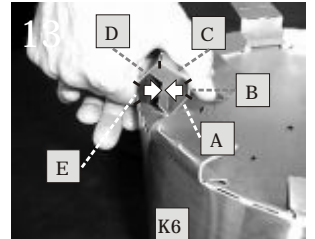
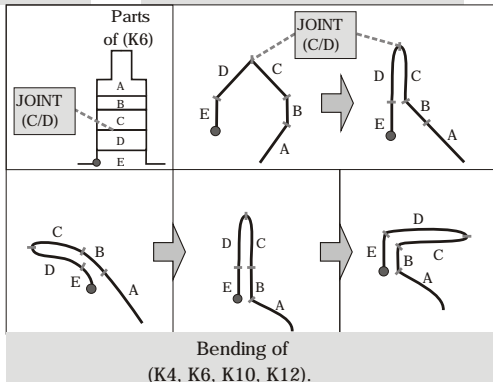

13 By installing (K6) insert (A) into hole (C2A) by bending at joints (E/D) (D/C) (C/B)(B/A). Press (D and C) together. Look at pictures (12, 12). (C2A) is visible in picture 8.

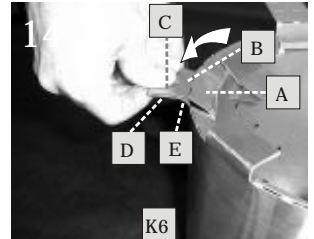

14 By installing (K6) press (C and D) together and turn them outwards 90° in order to pull (B) onto (E). Look at picture (12).

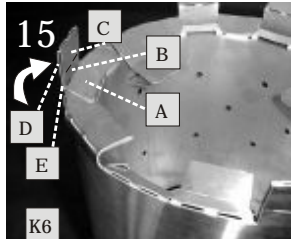

15 By installing (K6) press (C and D) (B and E) together and turn them inwards 90° in upright position, while bending at joint (A/B). Look at picture (12).

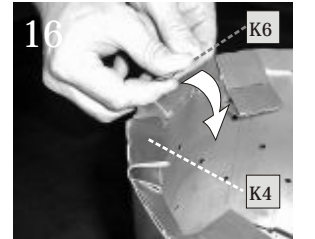

16 By installing (K6) 90° double-bend at joints (E/D) and (C/B) at the same time. Look at picture (12). Assemble (K4,K10,K12) in the same way as (K6): Pictures (12-16)

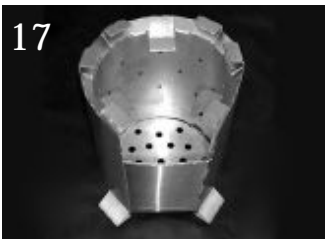

17 Upper part is also ready.

Phase E ASSEMBLY OF THE UPPER GRATE

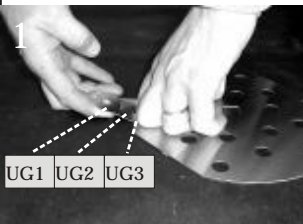

1 Hold upper grate (UG) down.

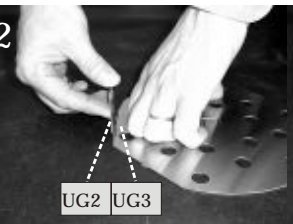

2 Bend at joint (UG2/UG3) 90°.

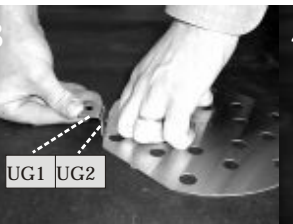

3 Bend at joint (UG1/UG2) 90°.

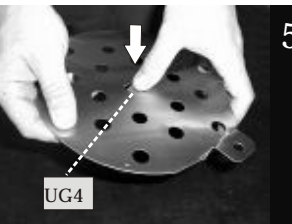

4 Push (UG4) down 90°.

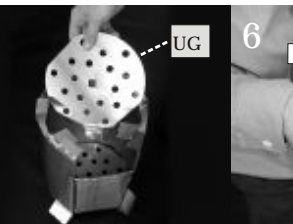

5 Insert upper grate (UG) into the stove.

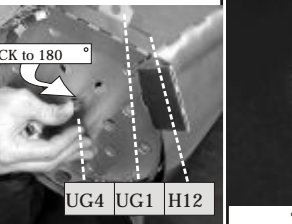

6 Install (UG1) through hole (H12) and (UG4) through hole (LG4). Bend (UG4) further to 180° until the upper grate locks.

Congratulations! Enjoy your cooking!

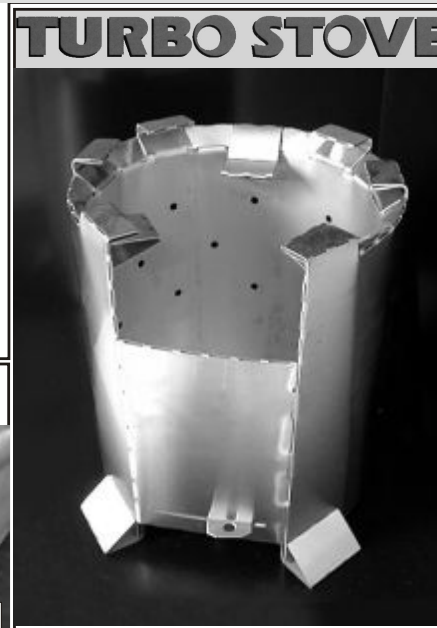

TURBO STOVE
TURBO STOVE / Tapio Niemi
Valtatie 216, 99100 Kittilä, FINLAND
Mobilephone +358 (0)40 535 4801
tapio.niemi@turbostove.fi
www.turbostove.fi